

# 76TH ANNUAL



*Sheraton Imperial*  
**DURHAM, NC**



# TLC<sup>®</sup> for LED<sup>®</sup>

Total Light Control™

## Control

from foundation to poletop ...

from the light source to the field,  
preserving the night sky ...

assuring the results you expect,  
day 1...year 1...and for 25 years.



Bob Lewis Ballpark - Candler, North Carolina



Local area representatives:

**Dina Neeley**  
336.414.1030 (mobile)  
dina.neeley@musco.com

**Brad Marolf**  
336.813.0194 (mobile)  
brad.marolf@musco.com

Scan here or go to  
[promo.musco.com/ncprdc](https://promo.musco.com/ncprdc)  
to learn more



©2022 Musco Sports Lighting, LLC - ADNC22-1

# REFRESH REFOCUS RENEW



**MCADAMS**  
creating experiences through experience

# DAILY AGENDA



RECREATION  
RESOURCES  
SERVICE

## NCPRDC AGENDA

### Wednesday, 1/31 Day 1

- 1:00-2:15 pm We are all TABs Conference Kick-Off
- 2:15-3:30 pm Using Native Plants in Park Landscaping
- 3:30-3:45 pm Break
- 3:45-5:00 pm RRS Research Update:  
*Status of Public Recreation in North Carolina*
- 5:30-7:00 pm Opening Reception

### Thursday, 2/1 Day 2

- 9:15-10:30 am How's your bench?
- 10:30-10:45 am Break
- 10:45-12:00 pm It's all about access
- 12:00-2:00 pm Recognition Lunch
- 2:15-3:30 pm Facilitated Round Table:  
*Trends and Issues from the Field*
- 3:30-3:45 pm Break
- 3:45-5:00 pm Making Users Count

### Friday, 2/2 Day 3

- 8:45-9:45 am NC State Parks and NCRPA Updates
- 9:45-11:15 am Swap Shop: *Discussion on Trends and Issues*

Please note that Wednesday and Thursday sessions will be held in Imperial 5-6-7.  
Friday sessions in the Crystal Coast Ballroom  
Thursday Lunch will be held in the Empire rooms.



# SESSION INFORMATION

**Weds., Jan 31**

**1:00-2:15 pm We are all TABs Conference Kick-Off**

**Speaker: Damian Buchman, Founder and Executive Director of the Ability Center**

In this session, attendees will gain a better understanding of the concept of planning programs, activities and projects that give everybody the opportunity to participate. TAB is Temporarily Able Bodied - what we all are!

**2:15-3:30 pm Using Native Plants in Park Landscaping**

**Panel led by Trey Fouche of RRS: Susan Hatchell, Vonda Martin, Preston Montague, Wyatt Richardson**

This session will focus on the benefits of using native plants in park landscaping, how to evaluate which native plants are the best "fit" for parks and how the NC-DNCR Native Plant policy will now require native plant landscaping with NC PARTF funded projects.

**3:45-5:00 pm RRS Research Update: Status of Public Recreation in North Carolina**

**Dr. Charlyne Smith and Krista White of Recreation Resources Service**

Presentation of the 2023 municipal and county services study results that examined NC public parks and recreation department facilities. Focus of this year's study is on Facilities.

**Thurs., Feb. 1**

**9:15-10:30 am How's Your Bench?**

**Panel led by Blake Covington of RRS: Dena Sabinske, Lee Jones and Rick Rocchetti**

Attendees will learn about a leader succession framework that can be followed to prepare the team. Hear how peers are approaching organization-planning, development of staff, and capturing institutional knowledge.

**10:45-12:00 pm It's All About Access**

**Speaker: Tara Barthelmess, Chief Accessibility Code Consultant with NC DOI**

Participants will gain a better understanding of relevant and current building codes and standards as they pertain to public facilities, parks and other recreation amenities. In addition, a review of the newly developed codes and requirements for facilities will be shared from the state and federal level.

**2:15-3:30 pm Facilitated Round Table: Trends and Issues from the Field**

Participants will gain a better understanding and different perspectives of relevant issues influencing provision of parks and recreation services through collective intelligence, peer interaction, and as a result, increase their knowledge and effectiveness as leaders.

1. Data Supported Storytelling - Beth Poovey, LandDesgin
2. How to Get the Most from your Consultant - Shweta, Jason and Nick, McAdams
3. Attracting All Ages - Suzanne Quinn, KOMPAN Play Institute
4. Concept to Construction: Navigating Your Next Big Project - Michael Tabeling, Domokur & Associates
5. Ask DPR / RRS - Staff from each will be available to answer grant specific questions and other resources information will be provided
6. Other - Open Table

**3:45-5:00 pm Making Users Count**

**Panel led by Alex Godette of RRS: Kris Nikfar, Lisa Kiser, Aaron Hipp, Abhi Muthiuan, Kara Martin**

As park system managers we seek to provide a safe and welcoming environment for visitors and staff alike. The desired user experience varies by location, activity and individual. Factors to consider not only include how visitors interact in a space but the potential impact to the resources in our care.

**Fri., Feb. 2**

**8:45-9:45 am Statewide Updates**

NC State Parks Grants and Outreach Manager, Vonda Martin and Executive Director Michelle Wells of NCRPA will provide a variety of updates from their organizations.

**9:45-11:15 am Swap shop: Discussion on Trends and Issues**

Bring your thoughts, questions, ideas and issues – the good, the bad and the ugly for this learning/sharing open discussion session of current issues and concerns in parks and recreation.

# SHERATON IMPERIAL

- Weds-Thursday Sessions: Imperial
- Exhibit Hall: Imperial - Weds 5:30 - 7:00pm Thursday 8:00 am - 3:45 pm
- Thursday Recognition Lunch : Empire
- Friday Sessions: Crystal Coast Ball room

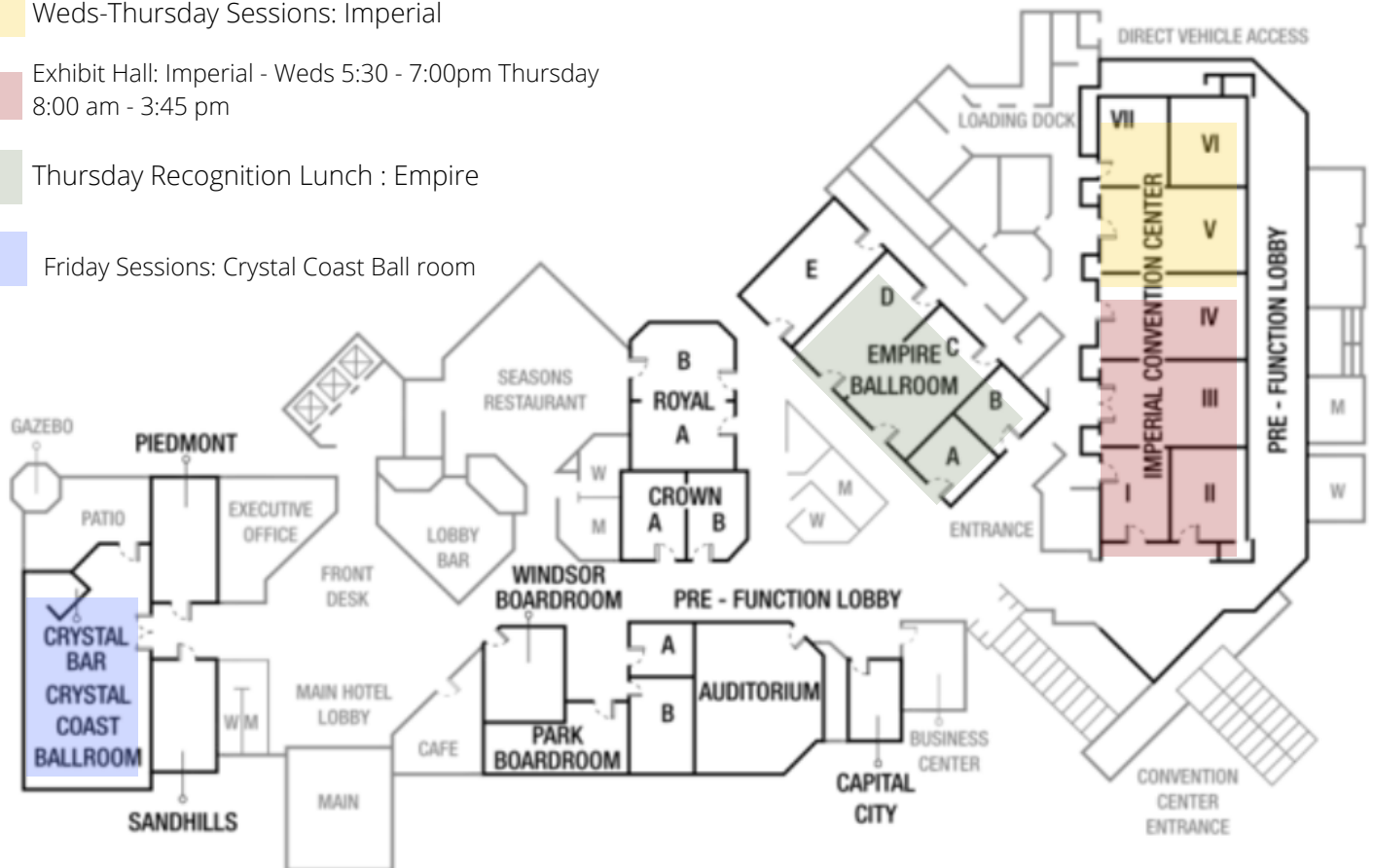

## Sheraton Imperial Hotel

Raleigh-Durham Airport at Research  
Triangle Park

4700 Emperor Blvd, Durham, NC 27703

(919) 941-5050

# THANK YOU

## TO OUR 2024 SPONSORS!

### GOLD SPONSORS

---



**We Make It Happen.®**



MCADAMS

# FRIENDS OF NCPRDC



WithersRavenel  
Our People. Your Success.



LandDesign.  
CREATING PLACES  
THAT MATTER.

Design • Build • PLAY!



Real People. Real Solutions.



TIMMONS GROUP

# GENERAL SPONSORS



CLARK  
NEXSEN



CPL  
ARCHITECTURE  
ENGINEERING  
PLANNING  
CPLteam.com

DOMOKUR + ASSOCIATES  
Architects | Designers | Planners

**Susan  
Hatchell**

*Landscape Architecture, PLLC*



**rec desk**



**PINNACLE**  
DRYER CORPORATION



OAKLEY  
COLLIER  
ARCHITECTS



**CAROLINA GOLF CARS**



**churchich**  
RECREATION & DESIGN



Engineers | Scientists | Planners | Designers

**Surface**





# 2024 NCPRDC EVENT EVALUATION

---

PLEASE COMPLETE THE COURSE EVALUATION:

[HTTPS://GO.NCSU.EDU/NCPRDCEVAL](https://go.ncsu.edu/ncprdcEval)

## KEEP UP WITH US AT:

---

EMAIL: [RECREATIONRESOURCES@NCSU.EDU](mailto:RECREATIONRESOURCES@NCSU.EDU)

WEBSITE : [HTTPS://RRS.CNR.NCSU.EDU](https://rrs.cnr.ncsu.edu)

OR FOLLOW US:

[TWITTER.COM/RECRESOURCESERV](https://twitter.com/RECRESOURCESERV)

[INSTAGRAM.COM/RECREATION\\_RESOURCES\\_SERVICE](https://www.instagram.com/recreation_resources_service)

[FACEBOOK.COM/RECREATIONRESOURCESSERVICE](https://www.facebook.com/recreationresourceservice)

SHARE YOUR CONFERENCE EXPERIENCE ON SOCIAL MEDIA USING THE

HASHTAG:

**#NCPRDC**

**SAVE THE DATE!**

**2025 NCPRDC**

**FEBRUARY 12-14**

**WINSTON-SALEM**